

ZIRCON® Tips from the Pros

Refer to the separate instruction sheet of tool (inserted between the product packaging card).

ILLUSTRATIONS ON THIS CARD MAY DIFFER FROM YOUR TOOL.

1. Read the instructions

Use only in accordance with tool's instructions (inserted between product packaging cards).

2. Use tape for markings

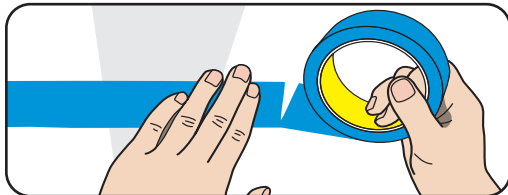

3. StudScan Mode



4. Find the edges

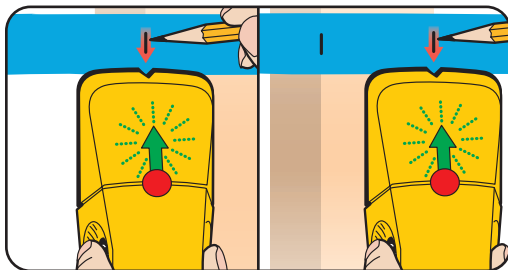

5. Mark the center

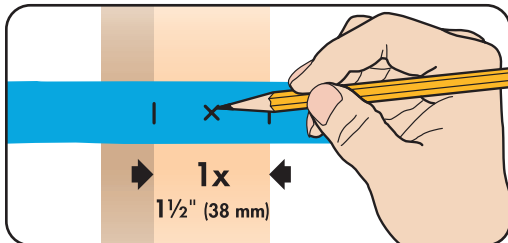

6. Recognize double or triple studs

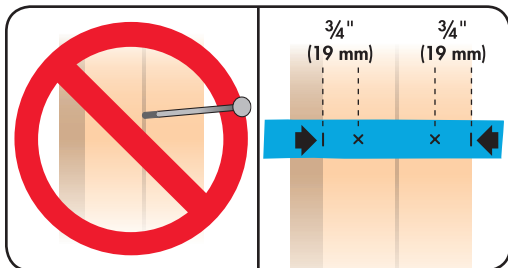
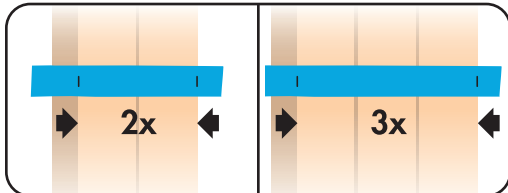

7. Recognize headers

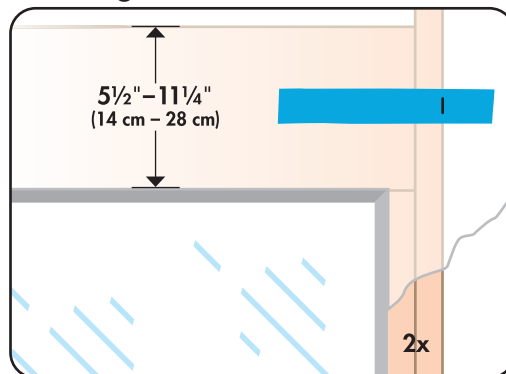

8. Map your wall

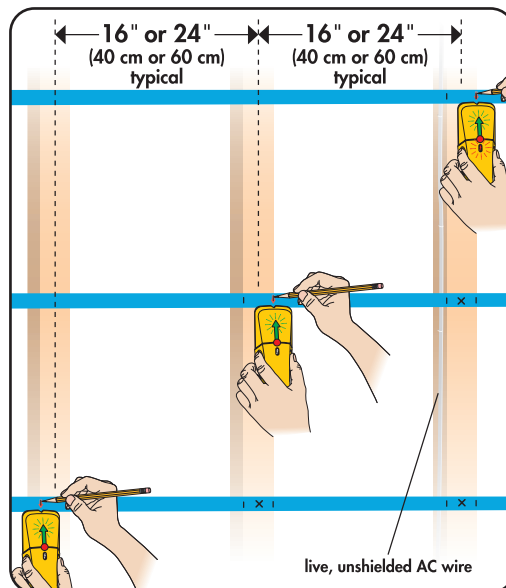

9. DeepScan® mode (select models only)



a) Thick walls

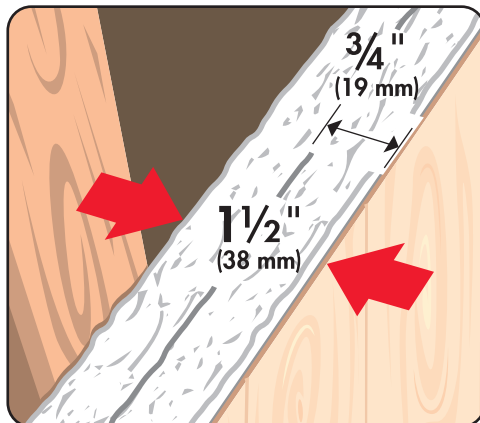

b) Textured surfaces

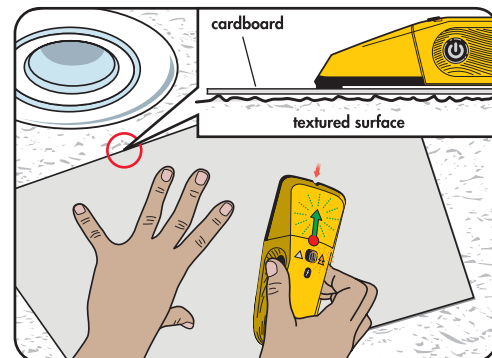

c) Flooring

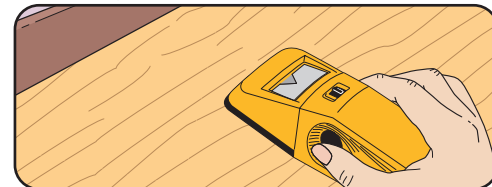

10. Hanging Mirrors & Pictures

- Fasten securely to center of studs.
- If a stud is not present, use appropriate anchors verified for the weight limit.
- Do not mistake ventilation or plumbing for a stud.

11. Shelving Installation

- Secure cabinets and shelves to center of studs, particularly where children may climb on them.
- Sketch possible options and buy additional pieces in case your shelving needs change later.
- Wire, wood, and melamine materials offer versatile shelving options.



Customer Service 1-800-245-9265
Monday-Friday, 8 am – 5 pm PST
www.zircon.com • info@zircon.com



© 2021. DeepScan and Zircon are registered trademarks or trademarks of Zircon Corporation.
GF-4699 Rev A 06/21